



# **BATTENS**

OVERLAP T8



### SPECIFICATIONS :

Mounting	: Surface Mounted (Ceiling / Wall)
Lamp type	: T8
Lamp holder	: G13
Control gear type	: Electronic
Voltage Rating/ Freq.	: 220-240V / 50-60 Hz
Power factor	: >0.95
Degree of protection	: IP 20
Internal Wiring	: 0.5 mm sq. solid copper wire, PVC 105 deg C .
Cable entry	: 16mm diam hole at the end/bottom of the housing
Cable connection	: Terminal block, 3-pole, screw type with grounding
Conformity	: IEC 60598 / SASO 1318
Optical system	: BL

**DESCRIPTIONS :** OVERLAP T8 is a Surface mounted cove light luminaire of 0.6 mm steel housing finished with 3-stages pretreatment electrostatic powder coating. It is available in two versions; as a bare lamp or with a white powder coated reflector. LOR reaches up to 91%. DIAL certified photometry. Energy efficiency is obtained using an electronic ballast with PF higher than 0.95.

**APPLICATIONS :** Cove lights applications.



# BATTENS

OVERLAP T8

## Glare Evaluation According to UGR

$\rho$ Ceiling	70	70	50	50	30	70	70	50	50	30	
$\rho$ Walls	50	30	50	30	30	50	30	50	30	30	
$\rho$ Floor	20	20	20	20	20	20	20	20	20	20	
Room Size X	Viewing direction at right angles to lamp axis					Viewing direction parallel to lamp axis					
Room Size Y											
2H	2H	19.4	20.5	20.0	21.2	22.0	16.7	17.9	17.4	18.5	19.3
	3H	22.0	23.1	22.7	23.8	24.6	18.4	19.4	19.0	20.1	20.9
	4H	23.2	24.2	24.0	25.0	25.8	18.9	19.9	19.6	20.6	21.5
	6H	24.4	25.3	25.1	26.1	27.0	19.3	20.2	20.0	21.0	21.8
	8H	25.0	25.9	25.7	26.6	27.5	19.4	20.3	20.1	21.0	21.9
4H	12H	25.5	26.4	26.3	27.1	28.0	19.4	20.2	20.1	21.0	21.9
	2H	19.8	20.8	20.5	21.5	22.4	17.9	18.9	18.6	19.6	20.5
	3H	22.7	23.6	23.5	24.3	25.2	19.9	20.8	20.7	21.5	22.4
	4H	24.2	24.9	24.9	25.7	26.6	20.7	21.5	21.5	22.3	23.2
	6H	25.5	26.2	26.3	27.0	28.0	21.3	22.0	22.1	22.8	23.7
8H	8H	26.2	26.8	27.0	27.6	28.6	21.5	22.1	22.3	22.9	23.9
	12H	26.9	27.4	27.7	28.3	29.2	21.5	22.1	22.3	22.9	23.9
	4H	24.4	25.1	25.2	25.9	26.9	21.7	22.3	22.5	23.1	24.1
	6H	26.1	26.6	26.9	27.4	28.4	22.6	23.1	23.4	24.0	25.0
	8H	26.9	27.4	27.7	28.2	29.2	22.9	23.4	23.8	24.3	25.3
12H	12H	27.8	28.2	28.6	29.0	30.1	23.2	23.6	24.0	24.4	25.5
	4H	24.4	25.0	25.3	25.8	26.8	21.9	22.5	22.7	23.3	24.3
	6H	26.1	26.6	27.0	27.5	28.5	23.0	23.5	23.8	24.3	25.4
	8H	27.1	27.5	27.9	28.3	29.4	23.5	23.9	24.3	24.8	25.8

Variation of the observer position for the luminaire distances S		
S = 1.0H	-0.1 / -0.1	+0.1 / -0.1
S = 1.5H	+0.2 / -0.2	+0.2 / -0.3
S = 2.0H	+0.3 / -0.4	+0.4 / -0.6
Standard table	BK 11	BK 13
Correction Summand	10.7	6.1

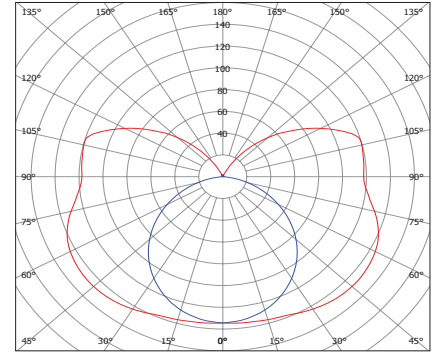

BAT-T8-1X18WE/BL (COVE)  
For the rest refer to page - 436

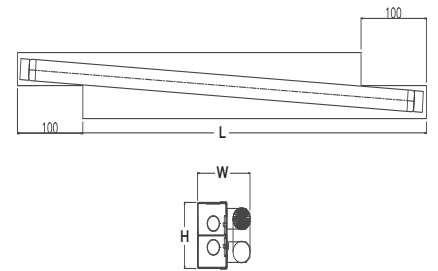

Corrected Glare Indices referring to 1350lm Total Luminous Flux  
The UGR values have been calculated according to CIE Publ. 117 Spacing-to-Height-Ratio = 1.00.

CODE	L	W	H	CODE	L	W	H
BAT-T8-1X18WE/BL [COVE]	625	80	80	BAT-T8-1X36WE/BL [COVE]	1235	80	80

### OPTIONS:

- Gear (DIM) [DALI]
- Emergency Kit [EM1.5] [EM3]
- Aluminium [ALU]



## Ordering Example

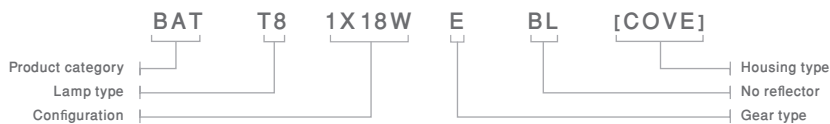

## Mounting System

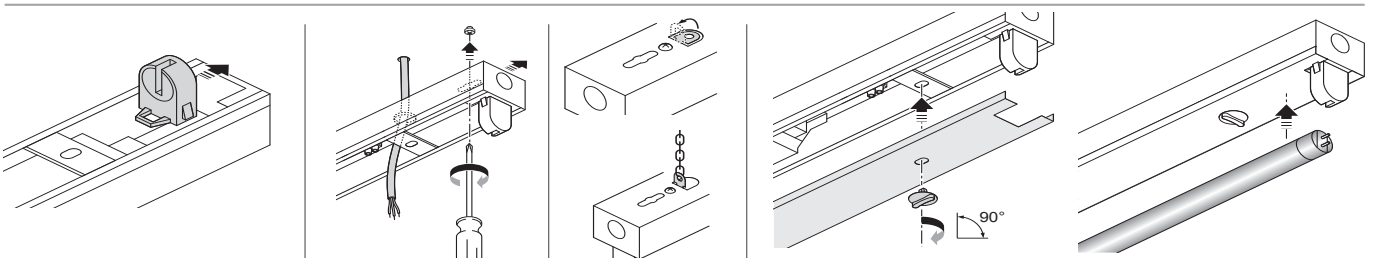

### **Head office**

Malaz - Salahidin Road  
P.O Box 1246 Riyadh 11431

Tel : +966 11 477 77 00  
Fax: +966 11 478 94 69

### **Western Region Office**

Tahliya Street  
P.O Box 20798 Jeddah 21465

Tel : +966 12 6650888  
Fax: +966 12 6633413

### **Eastern Region Office**

King Abdulaziz Street  
P.O Box 8492 Dammam 31482

Tel : +966 13 8336509  
Fax: +966 13 8329065

ContactUs@noortek.com



**[www.noortek.com](http://www.noortek.com)**