



DOWNLIGHTS

HALUX 3"ROUND

DOWNLIGHTS

HALUX 3"ROUND



SPECIFICATIONS :

Mounting	: Ceiling recessed
Lamp type	: Halogen
Lamp holder	: GU5.3
Control gear type	: HF Electronic transformer
Voltage Rating/ Freq.	: 220-240V / 60 Hz
Degree of protection	: IP 20/40
Internal Wiring	: 0.5 mm sq. solid copper wire PVC 105 deg C
Cable connection	: Terminal block, 2-pole, screw type with grounding
Conformity	: IEC 60598 / SASO 1318
Optical configuration	: CA / CA-CTG_D

DESCRIPTIONS : HALUX 3" Round is a recessed luminaire of die casted aluminum finished with 3-stages pretreatment electrostatic powder coating. The aluminum optic is used with purity higher than 99% and reflectance higher than 80% for LOR reaches up to 90% clear anodized finish. DIAL certified photometry. Energy efficiency is obtained using an electronic transformer.

APPLICATIONS : Decorative lighting scenes in shops, malls and fancy offices.



DOWNLIGHTS

HALUX 3"ROUND
WITHOUT DIFFUSER

Glare Evaluation According to UGR

Room Size		Viewing direction at right angles to lamp axis					Viewing direction parallel to lamp axis				
X	Y										
ρ Ceiling		70	70	50	50	30	70	70	50	50	30
ρ Walls		50	30	50	30	30	50	30	50	30	30
ρ Floor		20	20	20	20	20	20	20	20	20	20
2H	2H	6.0	6.8	6.2	7.0	7.2	8.2	9.0	8.4	9.2	9.4
	3H	7.6	8.3	7.9	8.5	8.8	8.9	9.7	9.2	9.9	10.1
	4H	8.5	9.2	8.8	9.4	9.7	9.5	10.1	9.8	10.4	10.7
	6H	9.3	9.9	9.6	10.2	10.4	10.1	10.7	10.4	10.9	11.2
	8H	9.5	10.1	9.8	10.4	10.7	10.2	10.8	10.6	11.1	11.4
	12H	9.6	10.2	9.9	10.5	10.8	10.3	10.8	10.6	11.1	11.4
4H	2H	6.3	7.0	6.6	7.2	7.5	8.3	8.9	8.6	9.2	9.4
	3H	8.2	8.8	8.5	9.1	9.4	9.3	9.9	9.7	10.2	10.5
	4H	9.3	9.8	9.7	10.2	10.5	10.1	10.6	10.5	10.9	11.3
	6H	10.3	10.7	10.7	11.0	11.4	10.9	11.3	11.3	11.6	12.0
	8H	10.5	10.9	11.0	11.3	11.7	11.1	11.5	11.5	11.9	12.3
	12H	10.7	11.0	11.1	11.4	11.8	11.2	11.5	11.6	11.9	12.3
8H	4H	9.8	10.1	10.2	10.5	10.9	10.4	10.8	10.8	11.2	11.6
	6H	10.9	11.1	11.3	11.6	12.0	11.4	11.6	11.8	12.1	12.5
	8H	11.2	11.4	11.6	11.9	12.3	11.7	11.9	12.1	12.3	12.8
	12H	11.3	11.5	11.8	12.0	12.5	11.7	11.9	12.2	12.4	12.9
12H	4H	9.8	10.1	10.2	10.5	11.0	10.4	10.8	10.9	11.2	11.6
	6H	10.9	11.2	11.4	11.6	12.1	11.4	11.7	11.9	12.1	12.6
	8H	11.3	11.5	11.8	12.0	12.4	11.7	11.9	12.2	12.4	12.9
Variation of the observer position for the luminaire distances S											
S =1.0H		+1.8 / -2.4					+1.7 / -2.2				
S =1.5H		+2.8 / -3.2					+2.7 / -3.2				
S =2.0H		+4.5 / -3.4					+4.4 / -3.6				
Standard table		BK02					BK01				
Correction Summand		-1.2					-1.5				

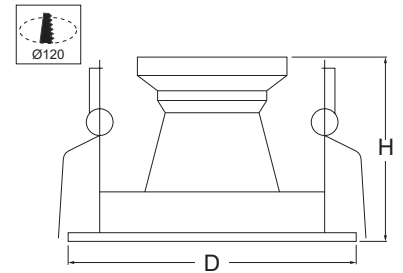
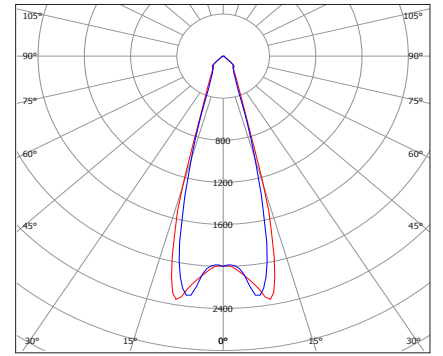

Corrected Glare Indices referring to 423lm Total Luminous Flux
The UGR values have been calculated according to CIE Publ. 117 Spacing-to-Height-Ratio = 1.00.

CODE	D	H
DLR(3'')-HAL-MR16-20W (WH)	138	80
DLR(3'')-HAL-MR16-35W (WH)	138	80
DLR(3'')-HAL-MR16-50W (WH)	138	80
DLR(3'')-HAL-MR16-20W/CA-CTG_D (WH)	138	80
DLR(3'')-HAL-MR16-35W/CA-CTG_D (WH)	138	80
DLR(3'')-HAL-MR16-50W/CA-CTG_D (WH)	138	80

OPTIONS:

- Dimmable transformer (1-10v/DALI)
- Emergency Kit (EM1.5) (EM3)
- Trim Color (WH) (BR) (CR) (AU) (NI) (SI)

Ordering Example

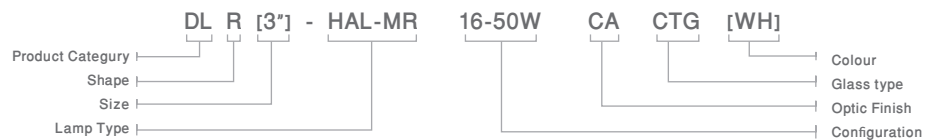

Mounting System

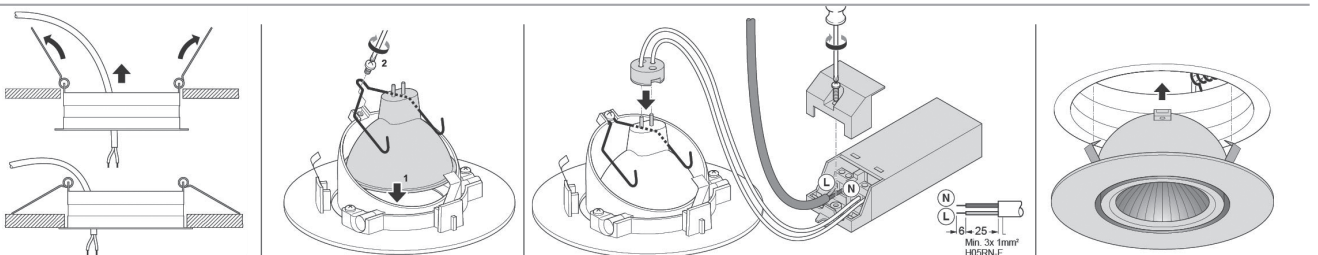

Head office

Malaz - Salahidin Road
P.O Box 1246 Riyadh 11431

Tel : +966 11 477 77 00
Fax: +966 11 478 94 69

Western Region Office

Tahliya Street
P.O Box 20798 Jeddah 21465

Tel : +966 12 6650888
Fax: +966 12 6633413

Eastern Region Office

King Abdulaziz Street
P.O Box 8492 Dammam 31482

Tel : +966 13 8336509
Fax: +966 13 8329065

ContactUs@noortek.com



www.noortek.com