



RECESSED

STRIP CEILING T8/T5

RECESSED

STRIP CEILING T8/T5



SPECIFICATIONS :

Mounting	: Ceiling recessed
Lamp type	: T8/T5
Lamp holder	: G13/G5
Control gear type	: Electronic
Voltage rating/ freq.	: 220-240V / 50-60 Hz
Power factor	: >0.95
Degree of protection	: IP 44
Internal wiring	: 0.5 mm sq. solid copper wire, PVC 105 deg C
Cable entry	: 16mm dia. hole on bottom of the housing
Cable connection	: Terminal block, 3-pole, screw type with grounding
Conformity	: IEC 60598 / SASO 1318
Light controller	: Prismatic (CP) / opal (CD)

DESCRIPTIONS :

Coverlux strip ceiling T8/T5 is a recessed luminaire of 0.6 mm steel housing finished with 3-stages pretreatment electrostatic powder coating. Plastic diffuser material is PMMA. High ingress protection degree (IP44) is available to be used in wet areas. Energy efficiency is obtained using electronic ballast with PF higher than 0.95.

APPLICATIONS :

Hospitals, laboratories, kitchens, clean rooms and industrial applications.

CODE	L	W	H	CODE	L	W	H
REC-T8-1X18WE-F/CP [STRIP] [IP44]	633	100	122	REC-T5-1X14WE-F/CP [STRIP] [IP44]	590	100	122
REC-T8-2X18WE-F/CP [STRIP] [IP44]	633	200	122	REC-T5-2X14WE-F/CP [STRIP] [IP44]	590	200	122
REC-T8-1X36WE-F/CP [STRIP] [IP44]	1243	100	122	REC-T5-1X28WE-F/CP [STRIP] [IP44]	1190	100	122
REC-T8-2X36WE-F/CP [STRIP] [IP44]	1243	200	122	REC-T5-2X28WE-F/CP [STRIP] [IP44]	1190	200	122

OPTIONS:

- Gear [DIM] [DALI] [2xEB]
- Emergency Kit [EM1.5] [EM3] [2xEM3] [DALI-EM3]



Ordering Example

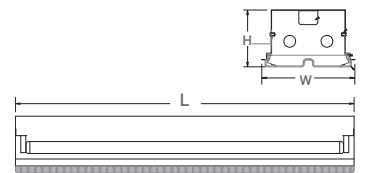
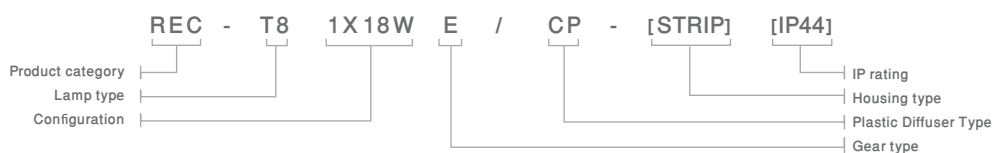

Mounting System

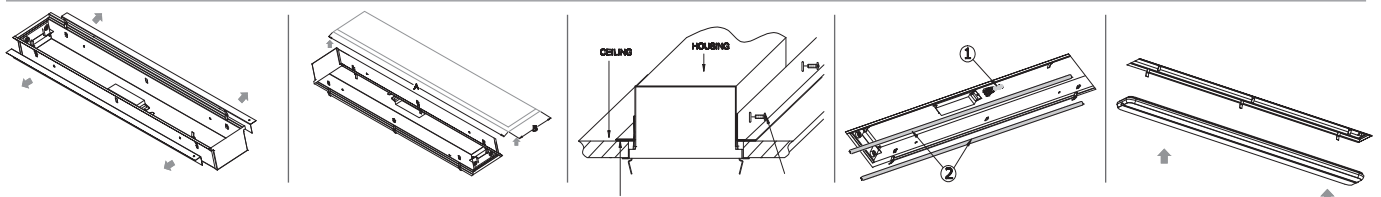

Head office

Malaz - Salahidin Road
P.O Box 1246 Riyadh 11431

Tel : +966 11 477 77 00
Fax: +966 11 478 94 69

Western Region Office

Tahliya Street
P.O Box 20798 Jeddah 21465

Tel : +966 12 6650888
Fax: +966 12 6633413

Eastern Region Office

King Abdulaziz Street
P.O Box 8492 Dammam 31482

Tel : +966 13 8336509
Fax: +966 13 8329065

ContactUs@noortek.com



www.noortek.com