



WALLUX
WUDL02X SERIES



DESCRIPTIONS

WUDL02X series is a professional LED wall mounting luminaire giving light up/down illumination. Luminaire body Die-cast aluminum body with high corrosion resistance polyester powder paint resistant to corrosion at harsh weather conditions, Diffuser is high pure aluminum reflector and clear safety glass. Stainless steel screws and sealed with silicone gaskets.

APPLICATIONS

Entrance, gates and other similar applications

DIMENSIONS

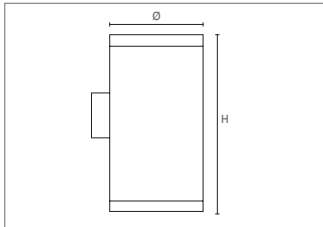

SPECIFICATIONS

Housing	Die-casting aluminum
LED module type	COB LED chips
Voltage rating/ freq.	220-240V / 50-60 Hz
Driver	Integral non-dimming driver
Beam Angle	15° & 24°
Degree of protection	IP 65
Light controller	Clear tempered glass
Housing color options	White, black and graphite
Standard color temp.	3000K/6000K
Rated lifetime (L70)	50,000 Hrs /70

CODE	Wattage	Lumin	IP Rate	Color Temp.	Beam Angle	Ø	H
WUDL02-2x7 W	14W	1190LM/1260LM	IP65	3000K/6000K	15°/24°	90	220
WUDL02-2x15 W	30W	2540LM/2700LM	IP65	3000K/6000K	15°/24°	140	450
WUDL02-2x20 W	40W	3400LM/3600LM	IP65	3000K/6000K	15°/24°	180	450

OPTIONS:
Dimmable Driver 1 - 10 / DALI
Backup Emergency Kit 1H/3H

MOUNTING SYSTEM

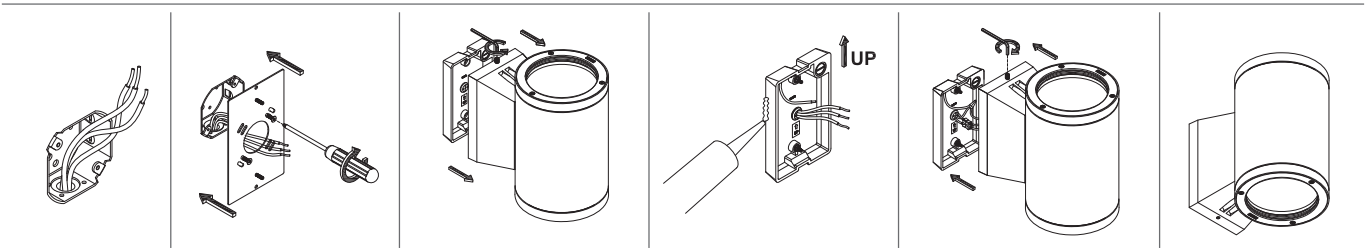

Head office

Malaz - Salahidin Road
P.O Box 1246 Riyadh 11431

Tel : +966 11 4777 700
Fax: +966 11 4789 469

Western Region Office

Tahliya Street
P.O Box 20798 Jeddah 21465

Tel : +966 12 6650888
Fax: +966 12 6633413

Eastern Region Office

King Abdulaziz Street
P.O Box 8492 Dammam 31482

Tel : +966 13 8336509
Fax: +966 13 8329065

ContactUs@noortek.com



www.noortek.com