



DOWNLIGHTS

HALUX 2"ROUND

DOWNLIGHTS

DOLUX 8" SURFACE IP20 CFL
WITHOUT DIFFUSER



SPECIFICATIONS :

Mounting	: Ceiling mounted
Lamp type	: CFL
Lamp holder	: G24q
Control gear type	: Electronic
Voltage Rating/ Freq.	: 220-240V / 50-60 Hz
Power factor	: >0.95
Degree of protection	: IP 20
Internal Wiring	: 0.5 mm sq. solid copper wire PVC 105 deg C
Cable connection	: Terminal block, 3-pole, screw type with grounding
Conformity	: IEC 60598 / SASO 1318
Light controller	: CA

DESCRIPTIONS : DOLUX 8" Surface is a surface mounted luminaire of 0.6 mm steel housing finished with 3-stages pretreated electrostatic powder Coating. The aluminum optic is used with purity higher than 99% and reflectance higher than 80% for high LOR. Many optic solutions give different distribution shapes. Energy efficiency is obtained using an electronic ballast with PF higher than 0.95.

APPLICATIONS : Stairs, corridors , concrete ceiling, multi-purposes halls and outdoor applications.

CODE	D	H
DLR-SU[8"]-CFL-1X18WE-F/CA	226	159
DLR-SU[8"]-CFL-2X18WE-F/CA	226	159
DLR-SU[8"]-CFL-1X26WE-F/CA	226	159
DLR-SU[8"]-CFL-2X26WE-F/CA	226	159

OPTIONS:

- Lamp holders (E27)
- Emergency Kit (EM1.5) (EM3)
- Trim Color (WH) (GR) (GLD)



Ordering Example

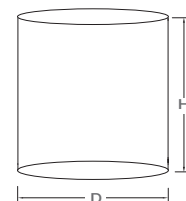

Mounting System

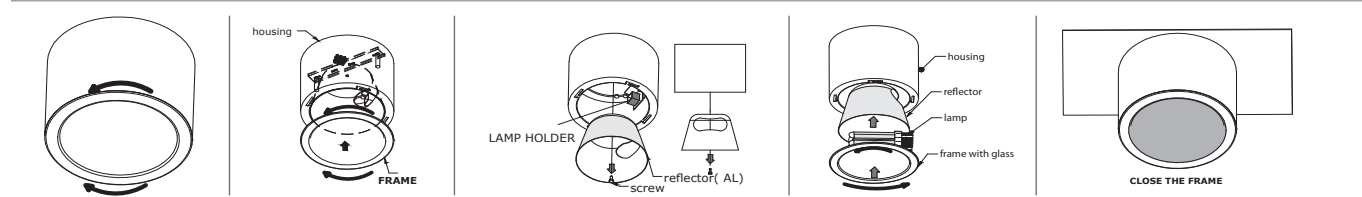

Head office

Malaz - Salahidin Road
P.O Box 1246 Riyadh 11431

Tel : +966 11 477 77 00
Fax: +966 11 478 94 69

Western Region Office

Tahliya Street
P.O Box 20798 Jeddah 21465

Tel : +966 12 6650888
Fax: +966 12 6633413

Eastern Region Office

King Abdulaziz Street
P.O Box 8492 Dammam 31482

Tel : +966 13 8336509
Fax: +966 13 8329065

ContactUs@noortek.com



www.noortek.com