



EXIT SIGN

SLIM S

SUSPENDED

EXIT SIGN

SLIM S

SUSPENDED



SPECIFICATIONS :

Mounting	: Suspended
Lamp configuration	: 8W T5
Lamp holder	: G5
Control gear type	: EM Backup Kit HF Electronic Ballast
Operating mode	: Maintain
Voltage Rating/ Freq.	: 220-240V / 50-60 Hz
Degree of protection	: IP 40
Internal wiring	: 0.5 mm sq solid copper wire PVC 105 deg C
Cable entry	: Side or rear cable entry
Cable connection	: Terminal block, 3-pole, screw type
Conformity	: IEC 60598 / SASO 1318

DESCRIPTIONS : EXITEK SLIM S is a ceiling suspended exit light of aluminium Housing with Maintained (M) 3 hrs emergency kit (1.5 Hr. as option). This type is suitable for all types of ceilings.

APPLICATIONS : Schools, offices and passages, hospitals, theaters and other similar applications.

	L	W	H
EXIT (SUS/ALU) M-3hr T5-1X8W - ARABIC/ENGLISH (WH)	422	59	334
EXIT (SUS/ALU) M-3hr T5-1X8W - ARROW UP (WH)	422	59	334
EXIT (SUS/ALU) M-3hr T5-1X8W - ARROW DOWN (WH)	422	59	334
EXIT (SUS/ALU) M-3hr T5-1X8W - ARROW LEFT (WH)	422	59	334
EXIT (SUS/ALU) M-3hr T5-1X8W - ARROW RIGHT (WH)	422	59	334
EXIT (SUS/ALU) M-3hr T5-1X8W - NO ARROW (WH)	422	59	334

OPTIONS:

- Emergency duration for 1.5 Hrs.
- High frequency (HF) electronic control gear for central battery systems (CBS) compatibility

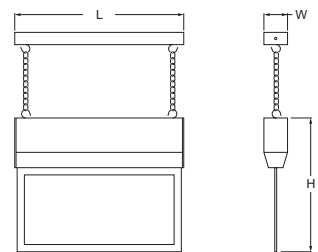

Ordering Example



Mounting System

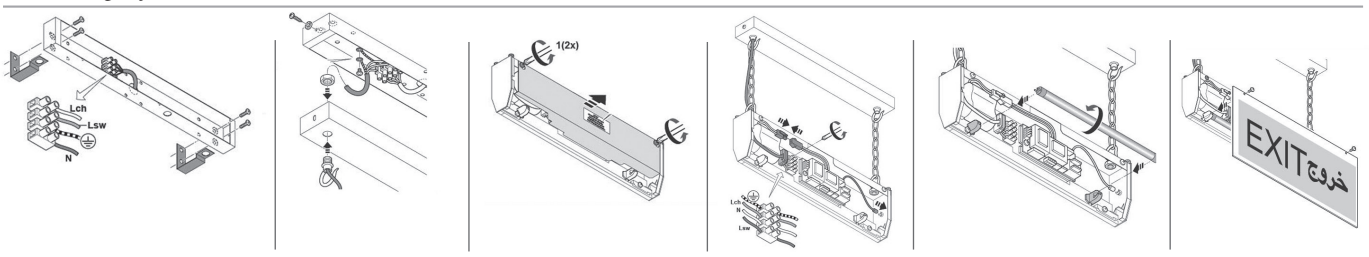

Head office

Malaz - Salahidin Road
P.O Box 1246 Riyadh 11431

Tel : +966 11 477 77 00
Fax: +966 11 478 94 69

Western Region Office

Tahliya Street
P.O Box 20798 Jeddah 21465

Tel : +966 12 6650888
Fax: +966 12 6633413

Eastern Region Office

King Abdulaziz Street
P.O Box 8492 Dammam 31482

Tel : +966 13 8336509
Fax: +966 13 8329065

ContactUs@noortek.com



www.noortek.com