



EXIT SIGN

STANDARD WALL/CEILING

EXIT SIGN

STANDARD

WALL /CEILING



SPECIFICATIONS :

Mounting	: Surface mounted (Wall / Ceiling)
Lamp configuration	: 8W T5
Lamp holder	: G5
Control gear type	: EM backup Kit HF Electronic Ballast
Operating mode	: Maintain / Non Maintain
Voltage rating/ Freq.	: 220-240V / 50-60 Hz
Degree of protection	: IP 40
Internal wiring	: 0.5 mm sq solid copper wire PVC 105 deg C
Cable entry	: Side or rear cable entry
Cable connection	: Terminal block, 3-pole, screw type
Conformity	: IEC 60598 / SASO 1318

DESCRIPTIONS : EXITEK STANDARD is a wall/ceiling mounted exit/emergency light of 0.6 mm steel housing finished with 3-stages pretreatment electrostatic powder coating with Maintained (M) and Non-Maintained (NM) 3 hrs emergency kit (1.5 Hr. as option). This type is suitable for all types of walls and ceilings.

APPLICATIONS : Schools, Offices and Passages, Hospitals, Theaters and other similar applications.

CODE	L	W	H	CODE	L	W	H
EXIT [WAL/METAL] M-3hr T5-1X8W - ARABIC/ENGLISH [WH]	375	73.5	178	EXIT [CEIL/METAL] NM-3hr T5-1X8W - ARABIC/ENGLISH [WH]	375	73.5	178
EXIT [WAL/METAL] M-3hr T5-1X8W - ARROW UP [WH]	375	73.5	178	EXIT [CEIL/METAL] NM-3hr T5-1X8W - ARROW UP [WH]	375	73.5	178
EXIT [WAL/METAL] M-3hr T5-1X8W - ARROW DOWN [WH]	375	73.5	178	EXIT [CEIL/METAL] NM-3hr T5-1X8W - ARROW DOWN [WH]	375	73.5	178
EXIT [WAL/METAL] M-3hr T5-1X8W - ARROW LEFT [WH]	375	73.5	178	EXIT [CEIL/METAL] NM-3hr T5-1X8W - ARROW LEFT [WH]	375	73.5	178
EXIT [WAL/METAL] M-3hr T5-1X8W - ARROW RIGHT [WH]	375	73.5	178	EXIT [CEIL/METAL] NM-3hr T5-1X8W - ARROW RIGHT [WH]	375	73.5	178
EXIT [WAL/METAL] M-3hr T5-1X8W - NO ARROW [WH]	375	73.5	178	EXIT [CEIL/METAL] NM-3hr T5-1X8W - NO ARROW [WH]	375	73.5	178

OPTIONS:

- Emergency duration for 1.5 Hrs.
- High frequency (HF) electronic control gear for central battery systems (CBS) compatibility

Ordering Example

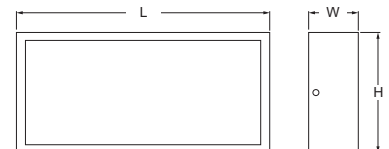

Mounting System

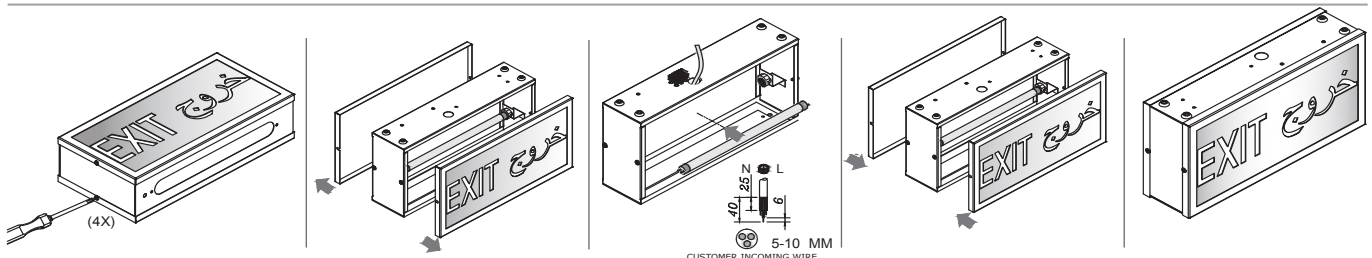

Head office

Malaz - Salahidin Road
P.O Box 1246 Riyadh 11431

Tel : +966 11 477 77 00
Fax: +966 11 478 94 69

Western Region Office

Tahliya Street
P.O Box 20798 Jeddah 21465

Tel : +966 12 6650888
Fax: +966 12 6633413

Eastern Region Office

King Abdulaziz Street
P.O Box 8492 Dammam 31482

Tel : +966 13 8336509
Fax: +966 13 8329065

ContactUs@noortek.com



www.noortek.com