



# VANDAL PROOF

RECESSED VANDALUX T5

# VANDAL PROOF

RECESSED

VANDALUX T5



## SPECIFICATIONS :

Mounting	: Ceiling recessed
Lamp type	: T5
Lamp holder	: G5
Control gear type	: HF Electronic
Voltage rating/ freq.	: 220-240V / 50-60 Hz
Power factor	: >0.95
Degree of protection	: IP 54/55
Internal wiring	: 0.5 mm sq. solid copper wire, PVC 105 deg C
Cable entry	: 16mm dia. hole on bottom of the housing
Cable connection	: Terminal block, 3-pole, screw type with grounding
Conformity	: IEC 60598 / SASO 1318
Light controller	: 6 mm clear polycarbonate diffuser

**DESCRIPTIONS :** VANDALUX T5 is a recessed luminaire of 1.0 mm G.I. housing finished with 3-stages pretreatment electrostatic powder coating. The 6mm PC cover offers maximum impact resistance up to IK10. It offer high IP protection for wet/dusty areas. The aluminum optic is used with purity higher than 99% and reflectance higher than 80%. Energy efficiency is obtained using an electronic ballast with PF higher than 0.95.

**APPLICATIONS :** Prisons, security centers, psychiatric hospital and other similar applications

CODE	L	W	H	CODE	L	W	H
REC-VAN-T5-2X14WE-F/CP6 (IP54/55)	597	297	100	REC-VAN-T5-2X28WE-F/CP6 (IP54/55)	1197	297	100
REC-VAN-T5-3X14WE-F/CP6 (IP54/55)	597	597	100	REC-VAN-T5-3X28WE-F/CP6 (IP54/55)	1197	597	100
REC-VAN-T5-4X14WE-F/CP6 (IP54/55)	597	597	100	REC-VAN-T5-4X28WE-F/CP6 (IP54/55)	1197	597	100

- OPTIONS:**
- Gear (DIM) (DALI)
  - Emergency Kit (EM1.5)
  - Aluminium (ALU)
  - Protection grid



## Ordering Example

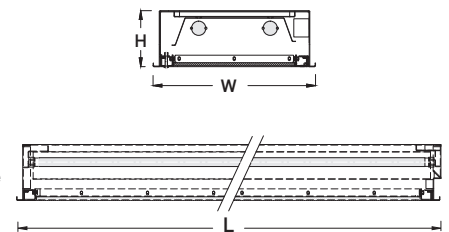
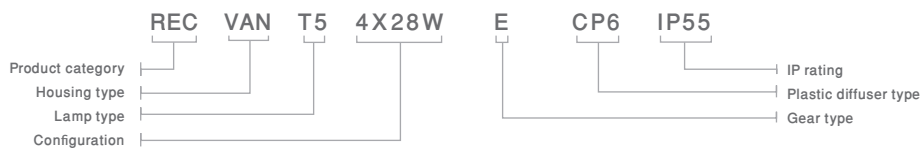

## Mounting System

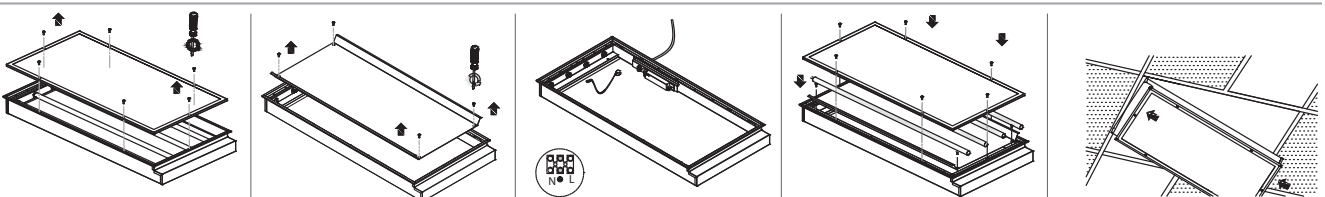

### **Head office**

Malaz - Salahidin Road  
P.O Box 1246 Riyadh 11431

Tel : +966 11 477 77 00  
Fax: +966 11 478 94 69

### **Western Region Office**

Tahliya Street  
P.O Box 20798 Jeddah 21465

Tel : +966 12 6650888  
Fax: +966 12 6633413

### **Eastern Region Office**

King Abdulaziz Street  
P.O Box 8492 Dammam 31482

Tel : +966 13 8336509  
Fax: +966 13 8329065

ContactUs@noortek.com



**[www.noortek.com](http://www.noortek.com)**